



ALLEN COUNTY JUSTICE CENTER



ELEVATUS
ARCHITECTURE

Commissioner Update
November 4, 2022
Elevatus Architecture

AGENDA – Status Update and Key Design Components

- (1) STATUS UPDATE
- (2) KEY PLANNING ITEMS
- (3) KEY COMPONENTS OF JAIL DESIGN
 - (1) HOUSING / SUPPORT
 - (2) MEDICAL
 - (3) MENTAL HEALTH / ADDICTION RECOVERY
- (4) Q/A

AGENDA – Status Update and Key Design Components

- (1) STATUS UPDATE
- (2) KEY PLANNING ITEMS
- (3) KEY COMPONENTS OF JAIL DESIGN
 - (1) HOUSING / SUPPORT
 - (2) MEDICAL
 - (3) MENTAL HEALTH / ADDICTION RECOVERY
- (4) Q/A

STATUS UPDATE – Programming and Conceptual

(1) PROGRAMMING

- Sheriff's Office Components
- Housing Programming and Support
- Medical
- Food and Laundry Services
- Next focused discussions
 - Intake / Release / Processing
 - Mental Health / Addiction Recovery

(2) PLANNING CONCEPTS

- Organizational Concepts
- Massing / Look and Feel

AGENDA – Status Update and Key Design Components

- (1) STATUS UPDATE
- (2) KEY PLANNING ITEMS
- (3) KEY COMPONENTS OF JAIL DESIGN
 - (1) HOUSING / SUPPORT
 - (2) MEDICAL
 - (3) MENTAL HEALTH / ADDICTION RECOVERY
- (4) Q/A

CONCEPTUAL AND LONG-TERM PLANNING

Planning for now and the future

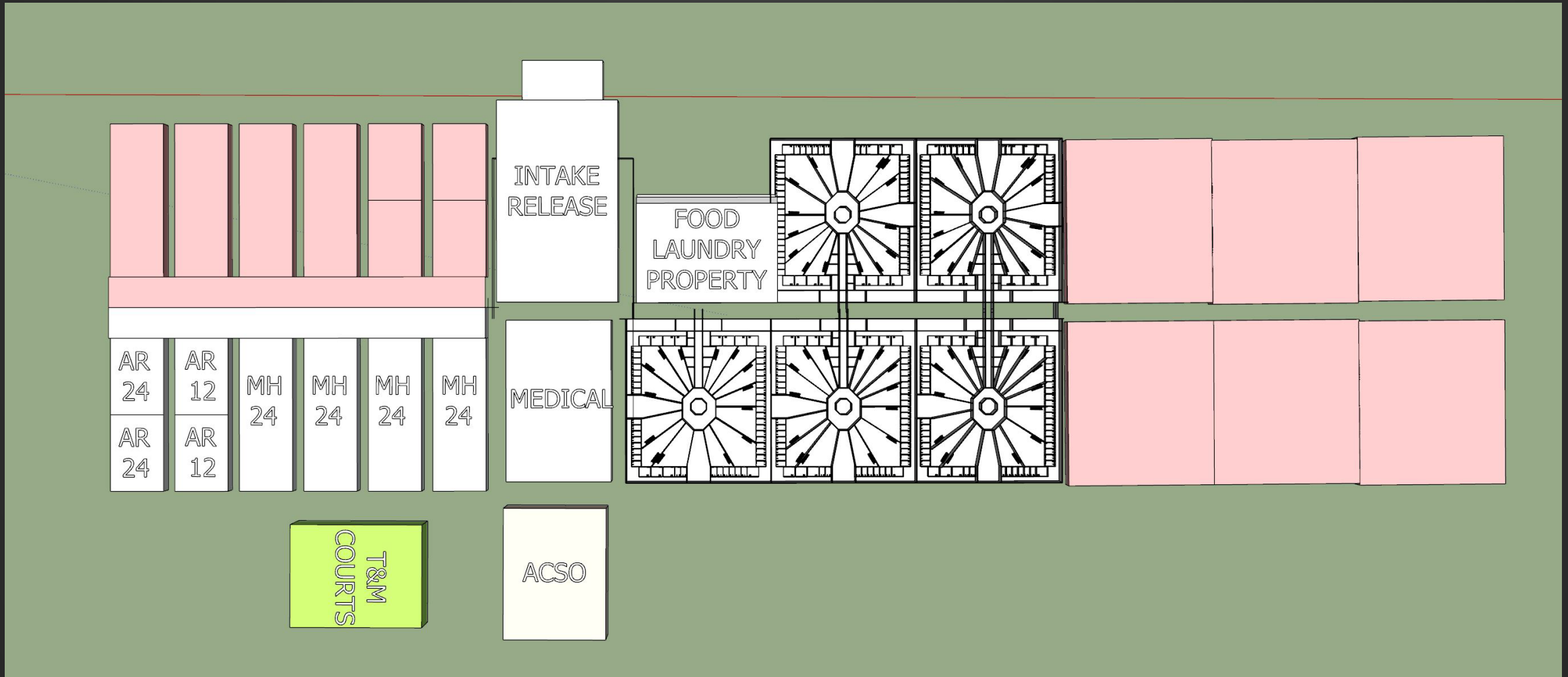

Commissioner Update

November 4, 2022

Elevatus Architecture

PRECEDENT FOR PLANNING

Civic but modest look and feel



Commissioner Update
November 4, 2022
Elevatus Architecture

CONCEPTUAL MASSING

Horizontal building – no towers



AGENDA – Status Update and Key Design Components

- (1) STATUS UPDATE
- (2) KEY PLANNING ITEMS
- (3) KEY COMPONENTS OF JAIL DESIGN
 - (1) HOUSING / SUPPORT
 - (2) MEDICAL
 - (3) MENTAL HEALTH / ADDICTION RECOVERY
- (4) Q/A

HOUSING DESIGN CONCEPT

Floor Plan – 225-250 Beds

- 12 Dayrooms / Classifications
- Various Sizes (12-32 beds)
- 2 Man Cells / 4 Man Cells / Dorms
- Optimum Flexibility for Classifications
- Multiple Recreation / Program Spaces
- Inmates have access to core services w/o moving throughout the building

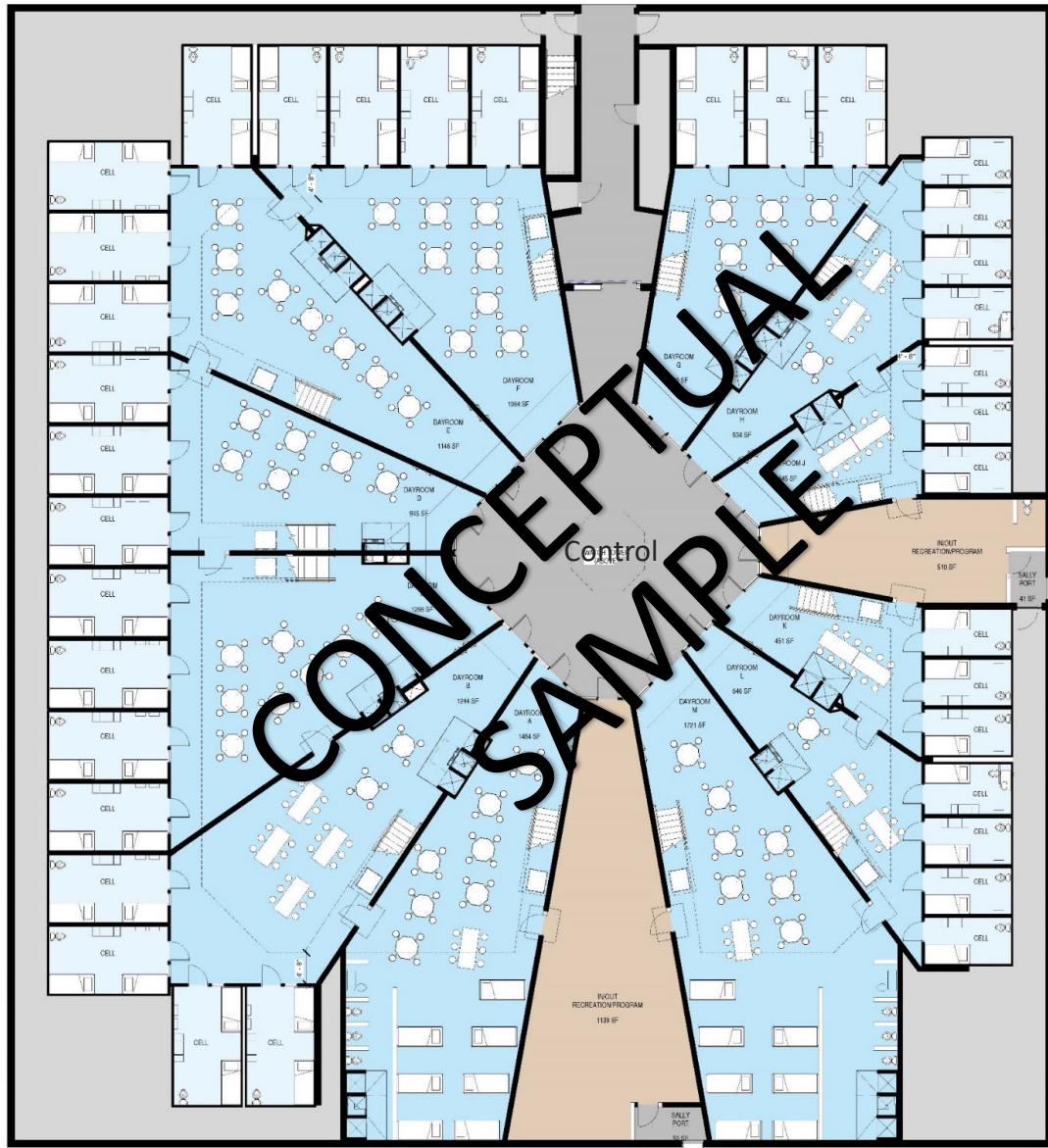

HOUSING CAPACITY

A	34	DORMITORY
B	32	4 MAN CELLS
C	32	4 MAN CELLS
D	24	4 MAN CELLS
E	32	4 MAN CELLS
F	32	4 MAN CELLS
G	24	4 MAN CELLS
H	16	2 MAN CELLS
J	12	2 MAN CELLS
K	12	2 MAN CELLS
L	16	2 MAN CELLS
M	34	DORMITORY
	300	TOTAL BEDS

Department Legend

CELL
CIRCULATION
DAYROOM
RECREATION
SUPPORT

Commissioner Update
November 4, 2022
Elevatus Architecture

HOUSING CONCEPT

Adams County Jail



RECREATION AND GROUP AREAS

Marion County Jail



MEDICAL CLINIC AND INFIRMARY



Medical Clinic and Infirmary

- Multi-bed Infirmary
- Exam Rooms
- Dental Procedures
- Triage Spaces
- Dialysis
- X-Ray / Imaging
- Pharmacy
- Physical Therapy / Occupational Therapy

MENTAL HEALTH HOUSING

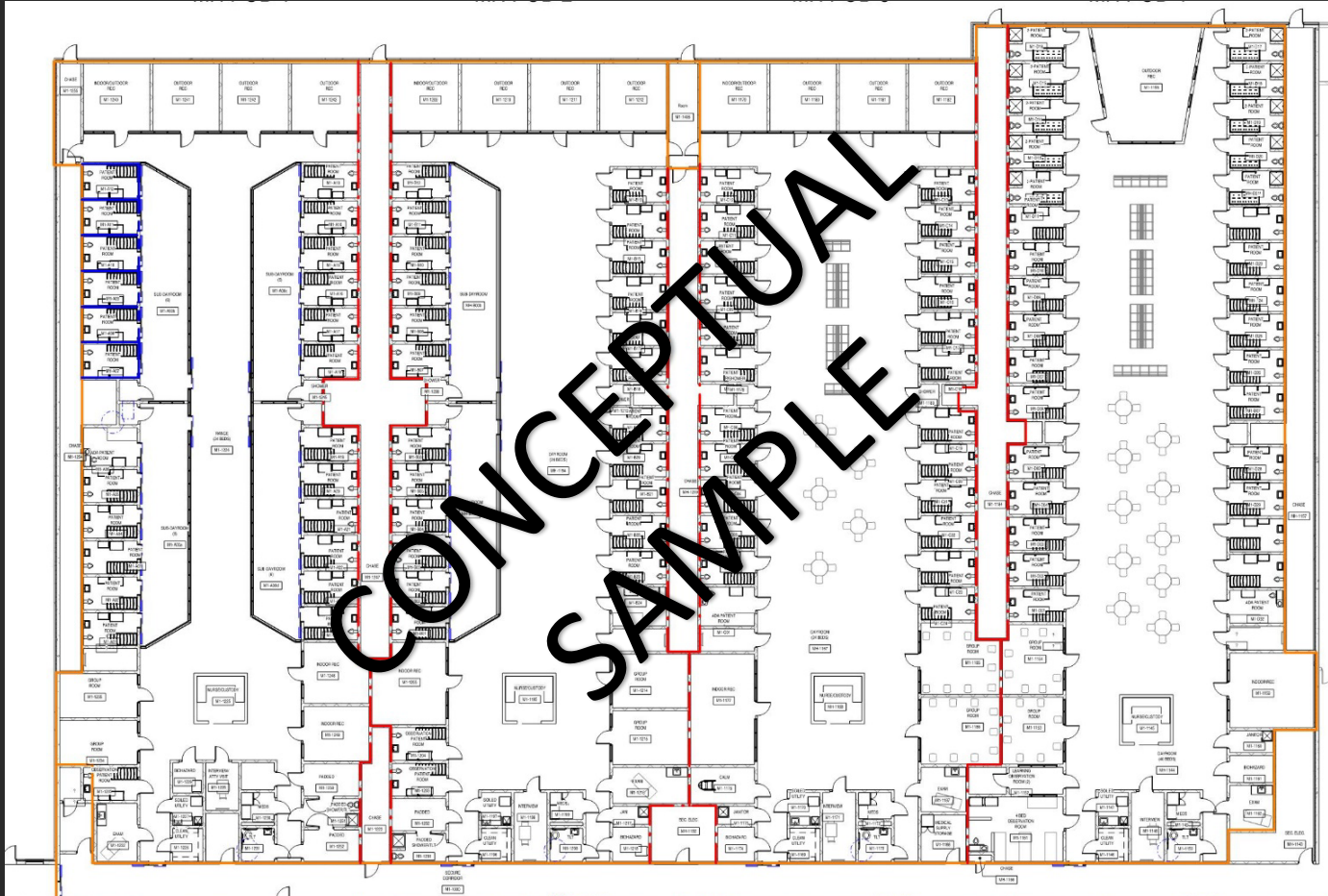

Mental Health Housing

- Dayrooms based on acuity
- Various Sizes (4-24)
- Single/ 2-Man Cells, Single Story
- 4 levels of Classification (one per range)
- Recreation, Group Therapy, Amenities

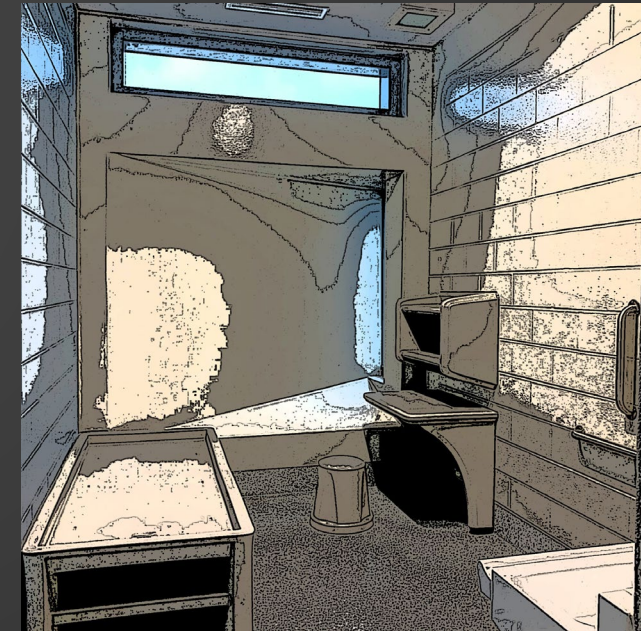

Commissioner Update
November 4, 2022
Elevatus Architecture

MENTAL HEALTH DAYROOMS AND SUPPORT



Commissioner Update

November 4, 2022

Elevatus Architecture

AGENDA – Status Update and Key Design Components

- (1) STATUS UPDATE
- (2) KEY PLANNING ITEMS
- (3) KEY COMPONENTS OF JAIL DESIGN
 - (1) HOUSING / SUPPORT
 - (2) MEDICAL
 - (3) MENTAL HEALTH / ADDICTION RECOVERY
- (4) Q/A



Thank you.

For more information:

Elevatus Architecture
www.elevatusarchitecture.com
260.424.9080